



2 bed apartment to buy in N1

Hobbs Place Estate, Hackney, London, ., N1 5HY

£325,000 Starting Bid

 x2  x1  x1

Tenure

Leasehold

Off Street parking

Property features

- ✓ Being Sold via Secure Sale online bidding. Terms and Conditions
- ✓ Two Bedroom Flat
- ✓ Sixth Floor
- ✓ Good Condition Throughout
- ✓ EPC Rating C

Key Information

- ✓ Council Tax: Band B
- ✓ EPC Rating: C
- ✓ Heating supply: Gas
- ✓ Electric supply: National Grid
- ✓ Water supply: Direct mains water
- ✓ Broadband: FTTC (fibre to the cabinet)
- ✓ Mobile signal: Good

Description

Pattinson Auction are pleased to present this well-maintained property situated in the charming Hobbs Place Estate.

The residence is in excellent condition and ready for immediate occupancy, making it an ideal choice for first-time buyers or investors looking to rent out.

Offering a convenient location with easy access to local amenities and public transport, this home ensures both comfort and convenience.

This is truly a great opportunity for anyone looking to invest in a property that is both appealing and practical.

Council Tax Band: B

Tenure: Leasehold

Length of Lease: 103

Annual Ground Rent Amount: £10.00

Annual Service Charge Amount: £2,222.00

Price: Starting Bid £325,000

Property Type: Apartment

Parking: Off Street

Construction materials: Brick and block

Roofing type: Flat

Risk of floods and or erosion: No

Flooded in last 5 years: No

Flood defences: No

Planning permissions or proposals for development: No

Coalfield or mining area: No

Listed property: No

Conservation area: No

Public rights of way: No

Adaptions for accessibility: No

Restrictions: No

Required access: No

Heating: Gas

Electric: National Grid

Water: Direct mains water

Water meter: No

Sewerage: Standard UK domestic

Air conditioning: No

Broadband: FTTC (fibre to the cabinet)

Mobile signal coverage: Good

6TH FLOOR

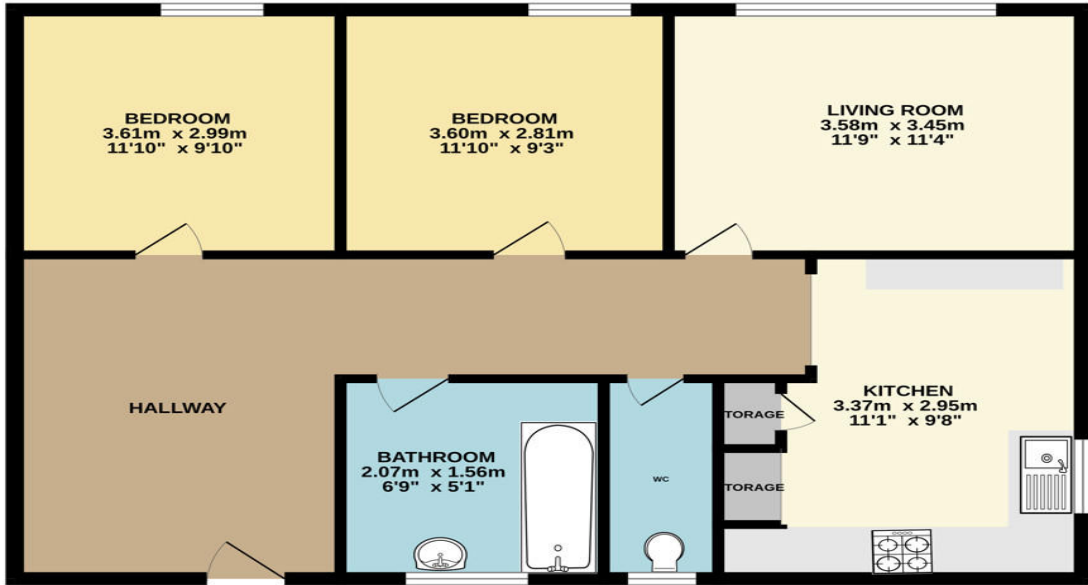

Whilst every attempt has been made to ensure the accuracy of the floorplan contained here, measurements of doors, windows, rooms and any other items are approximate and no responsibility is taken for any error, omission or mis-statement. This plan is for illustrative purposes only and should be used as such by any prospective purchaser. The services, systems and appliances shown have not been tested and no guarantee as to their operability or efficiency can be given.
Made with Metropix ©2024

Energy Efficiency Rating		
	Current	Potential
<i>Very energy efficient - lower running costs</i>		
(92-100) A		
(81-91) B		
(69-80) C	79	79
(55-68) D		
(39-54) E		
(21-38) F		
(1-20) G		
<i>Not energy efficient - higher running costs</i>		
England, Scotland & Wales	EU Directive 2002/91/EC	

Hobbs Place Estate, Hackney, London, ., N1 5HY

Contact your local branch today for more information on this property:

1000 Great West Road, Brentford, Brentford, Middlesex, TW8 9DW, Tel: 0208 106 8888, <https://openhouse.london/>

These particulars, whilst believed to be accurate are set out as a general outline only for guidance and do not constitute any part of an offer or contract. Intending purchasers should not rely on them as statements of representation of fact, but must satisfy themselves by inspection or otherwise as to their accuracy. No person in this firms employment has the authority to make or give any representation or warranty in respect of the property.

