



## 2 bed apartment to buy in SL1

5 Bath Road, Berkshire, Slough, Berkshire,  
SL1 3FX

**£200,000** Starting Bid

 x 2  x 2  x 1

Tenure

**Leasehold**

Allocated parking

## Property features

- ✓ Being sold via Secure Sale online bidding. Terms & Conditions apply
- ✓ Lift Access
- ✓ Underground Parking
- ✓ Good Location
- ✓ EPC Rating C

## Key Information

- ✓ Council Tax: Band C
- ✓ EPC Rating: C
- ✓ Heating supply: Electric
- ✓ Electric supply: National Grid
- ✓ Water supply: Direct mains water
- ✓ Broadband: FTTP (fibre to the premises)
- ✓ Mobile signal: Good

## Description

Brickfield Court is a sought-after development situated on the Bath Road and conveniently located within walking distance of Slough mainline railway station (Elizabeth Line) and Slough High Street. This two bedroom, two bathroom property, offers the latest contemporary fixtures and fittings, Bosch appliances, oak flooring & an allocated underground parking space.

The property further benefits from video entryphone, lift service, bespoke oak timber flooring, Bosch appliances, electric heating, dedicated parking space and residents use of the gym and concierge.

Council Tax Band: C

Tenure: Leasehold

Length of Lease: 991

Annual Ground Rent Amount: £420.00

Annual Service Charge Amount: £3,600.00

Price: Starting Bid £200,000

Property Type: Apartment

Parking: Allocated

Construction materials: Brick and block

Roofing type: Metal roofing

Heating: Electric

Electric: National Grid

Water: Direct mains water

Water meter: Yes

Sewerage: Standard UK domestic

Air conditioning: No

Broadband: FTTP (fibre to the premises)

Mobile signal coverage: Good

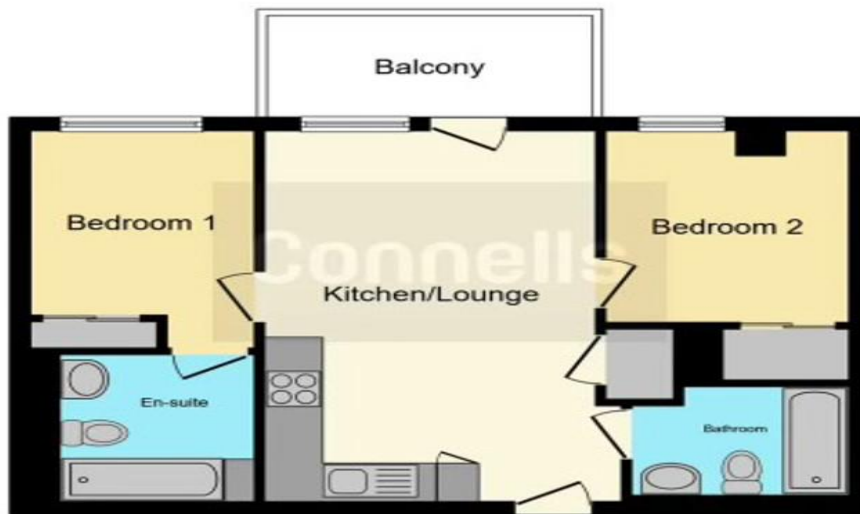

This floorplan is for illustrative purposes only and is not drawn to scale. Measurements, floor-areas, openings and orientations are approximate. They should not be relied upon for any purpose and do not form any part of an agreement. No liability is taken for any error or mis-statement. All parties must rely on their own inspections.

| Energy Efficiency Rating                           |                            |           |
|--|----------------------------|-----------|
|  | Current                    | Potential |
| <i>Very energy efficient - lower running costs</i> |                            |           |
| (92-100) <b>A</b>                                  |                            |           |
| (81-91) <b>B</b>                                   |                            | 83        |
| (69-80) <b>C</b>                                   | 77                         |           |
| (55-68) <b>D</b>                                   |                            |           |
| (39-54) <b>E</b>                                   |                            |           |
| (21-38) <b>F</b>                                   |                            |           |
| (1-20) <b>G</b>                                    |                            |           |
| <i>Not energy efficient - higher running costs</i> |                            |           |
| <b>England, Scotland &amp; Wales</b>               | EU Directive<br>2002/91/EC |           |

5 Bath Road, Berkshire, Slough, Berkshire, SL1 3FX

Contact your local branch today for more information on this property:

**1000 Great West Road, Brentford, Brentford, Middlesex, TW8 9DW, Tel: 0208 106 8888,  
<https://openhouse.london/>**

These particulars, whilst believed to be accurate are set out as a general outline only for guidance and do not constitute any part of an offer or contract. Intending purchasers should not rely on them as statements of representation of fact, but must satisfy themselves by inspection or otherwise as to their accuracy. No person in this firm's employment has the authority to make or give any representation or warranty in respect of the property.

