



1 bed studio flat to buy in BA2

17 Lower Oldfield Park, Oldfield Park,
Bath, Somerset, BA2 3HL

£137,500 Starting Bid

 x1  x1  x1

Tenure

Share Of Freehold

On Street parking

Property features

- ✓ Being Sold via Secure Sale Online Bidding T&C's Apply
- ✓ One Bedroom Apartment
- ✓ Ground Floor
- ✓ Share of Freehold
- ✓ EPC Rating D

Key Information

- ✓ Council Tax: Band A
- ✓ EPC Rating: D
- ✓ Heating supply: Gas
- ✓ Electric supply: National Grid
- ✓ Water supply: Direct mains water
- ✓ Broadband: FTTP (fibre to the premises)
- ✓ Mobile signal: Good

Description

We are delighted to offer to the market a ground floor studio flat on Lower Oldfield Park, with separate kitchen and bathroom.

The property offers a well-designed layout and comfortable accommodation supporting a wide array of individual activities.

This property will be legally prepared enabling any interested buyer to secure the property immediately once their bid/offer has been accepted. Ultimately a transparent process which provides speed, security and certainty for all parties.

The Property

We are delighted to offer to the market this well presented ground floor studio flat on Lower Oldfield Park, Somerset. The property offers a well-designed layout and comfortable accommodation supporting a wide array of individual activities. This property has accommodation briefly comprising; The living room draws in an abundance of natural daylight creating a bright and airy feeling throughout with ample room for a dining table for two. The kitchen is fully equipped with fittings including sleek mounted units and contemporary work surfaces. The bathroom room comprises of a toilet, hand washing basin and a bath with shower over. Externally to the rear of the property there is a shared garden ideal for outdoor seating. Less than a 1-mile drive away is Bath Railway Station direct connections to London and also Oldfield Park Railway Station which provides services to Bristol Temple Meads as well as Gloucester, Salisbury (truncated)

Council Tax Band: A

Tenure: Share Of Freehold

Length of Lease: 985

Annual Service Charge Amount: £1,680.00

Price: Starting Bid £137,500

Property Type: Studio flat

Parking: On Street, Permit Parking

Construction materials: Stone built

Roofing type: Clay tiles

Risk of floods and or erosion: No

Flooded in last 5 years: No

Flood defences: No

Planning permissions or proposals for development: No

Coalfield or mining area: No

Listed property: No

Conservation area: No

Public rights of way: No

Adaptions for accessibility: No

Restrictions: No

Required access: No

Heating: Gas

Electric: National Grid

Water: Direct mains water

Water meter: Yes

Sewerage: Standard UK domestic

Air conditioning: No

Broadband: FTTP (fibre to the premises)

Mobile signal coverage: Good

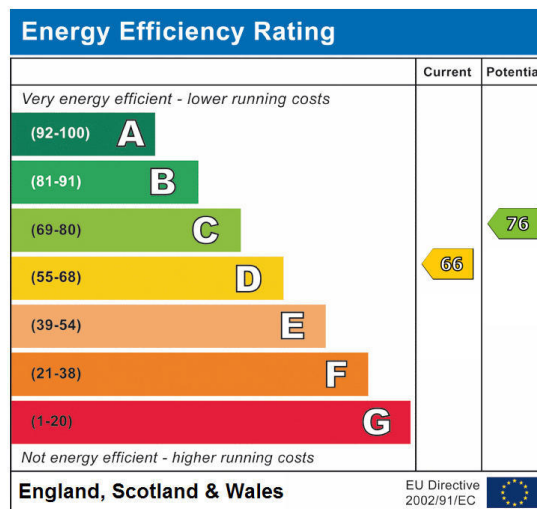
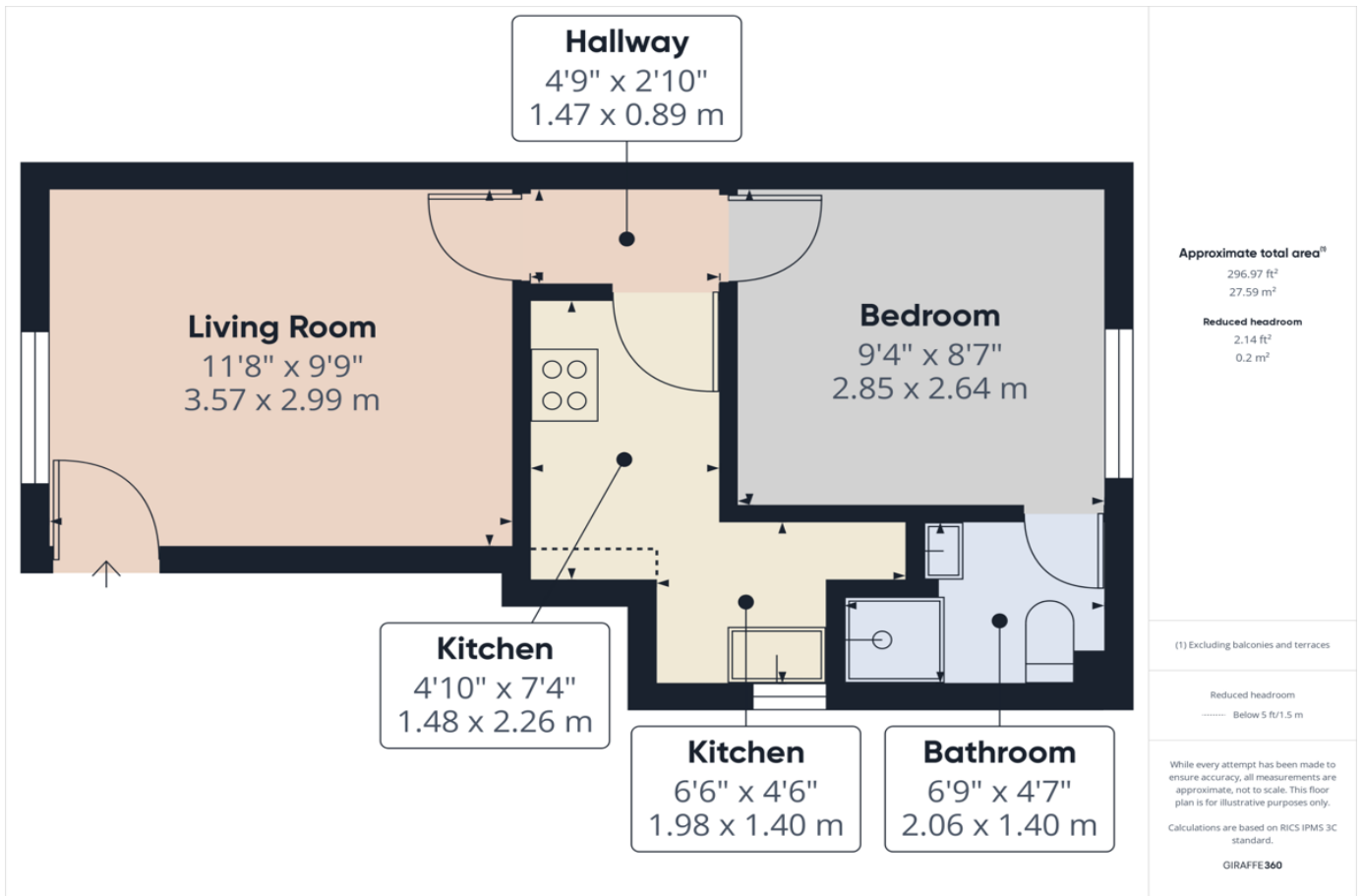

17 Lower Oldfield Park, Oldfield Park, Bath, Somerset, BA2 3HL

Contact your local branch today for more information on this property:

1000 Great West Road, Brentford, Brentford, Middlesex, TW8 9DW, Tel: 0208 106 8888,

<https://openhouse.london/>

These particulars, whilst believed to be accurate are set out as a general outline only for guidance and do not constitute any part of an offer or contract. Intending purchasers should not rely on them as statements of representation of fact, but must satisfy themselves by inspection or otherwise as to their accuracy. No person in this firm's employment has the authority to make or give any representation or warranty in respect of the property.

