



To buy

## 3 bed semi-detached house to buy in TS4

Gilkes Walk, Middlesbrough,  
Middlesbrough, North Yorkshire, TS4 3RT

# £150,000

🏠 x3 🚿 x2 🚻 x1

Tenure

**Freehold**

Allocated parking

## Property features

- ✓ No Forward Chain
- ✓ Master Bedroom with En-Suite
- ✓ Rear Garden
- ✓ Within Reach to James Cook Hospital and Stewarts Park
- ✓ EPC Rating C

## Key Information

- ✓ Council Tax: Band B
- ✓ EPC Rating: C
- ✓ Heating supply: Gas

## Description

\*\*\*\*\*No Forward Chain\*\*\*\*\*

Located in a popular residential area of Middlesbrough, this well-presented three-bedroom semi-detached property offers modern living accommodation ideal for families, first-time buyers, or professionals.

The ground floor briefly comprises a welcoming entrance hall leading to a spacious lounge, providing a comfortable and relaxing living space and provides access to the rear garden. The modern kitchen offers ample storage and worktop space. A convenient downstairs WC completes the ground floor accommodation. To the first floor are three well-proportioned bedrooms, including a master bedroom with en-suite shower room, offering added privacy and convenience. The remaining bedrooms are serviced by a family bathroom. Externally, the property benefits from a rear garden, ideal for outdoor entertaining, gardening, or family use.

Situated within reach of local amenities, schools, transport links, James Cook Hospital and Stewarts Park, Gilkes Walk is a fantastic opportunity to acquire a comfortable and practical home in a sought-after location.

For more information and to arrange an internal inspection contact the Stockton branch today.

Council Tax Band: B

Tenure: Freehold

Price: £150,000

Property Type: Semi-detached house

Parking: Allocated

Heating: Gas

## Entrance

---

## Hallway

---

## WC

1.76m x 0.95m (5'9" x 3'1")



## Lounge

4.81m x 4.45m (15'9" x 14'7")

---

## Kitchen

3.39m x 2.68m (11'1" x 8'9")

---

## 1st Floor Landing

---

## Bedroom 1

4.08m x 2.69m (13'4" x 8'9")



## En-Suite

2.668m x 1.40m (8'9" x 4'7")

---

## Bedroom 2

3.03m x 2.70m (9'11" x 8'10")



## Bedroom 3

2.12m x 1.97m (6'11" x 6'5")



## Family Bathroom

2.06m x 1.91m (6'9" x 6'3")



## External



## Floor Plan



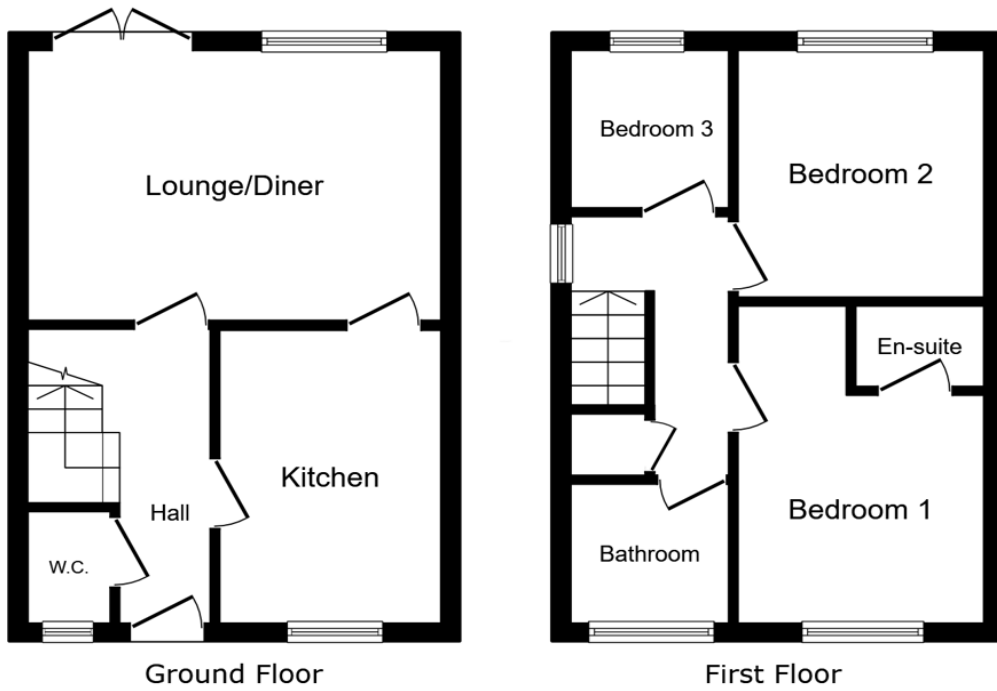

This floor plan is for illustrative purposes only. It is not drawn to scale. Any measurements, floor areas (including any total floor area), openings and orientations are approximate. No details are guaranteed, they cannot be relied upon for any purpose and do not form any part of any agreement. No liability is taken for any error, omission or misstatement. A party must rely upon its own inspection(s). Powered by www.Propertybox.io

Energy Efficiency Rating		
	Current	Potential
<i>Very energy efficient - lower running costs</i>		
(92-100) <b>A</b>		92
(81-91) <b>B</b>		
(69-80) <b>C</b>	79	
(55-68) <b>D</b>		
(39-54) <b>E</b>		
(21-38) <b>F</b>		
(1-20) <b>G</b>		
<i>Not energy efficient - higher running costs</i>		
<b>England, Scotland &amp; Wales</b>		EU Directive 2002/91/EC 

Gilkes Walk, Middlesbrough, Middlesbrough, North Yorkshire, TS4 3RT

Contact your local branch today for more information on this property:

**1000 Great West Road, Brentford, Brentford, Middlesex, TW8 9DW, Tel: 0208 106 8888,  
<https://openhouse.london/>**

These particulars, whilst believed to be accurate are set out as a general outline only for guidance and do not constitute any part of an offer or contract. Intending purchasers should not rely on them as statements of representation of fact, but must satisfy themselves by inspection or otherwise as to their accuracy. No person in this firm's employment has the authority to make or give any representation or warranty in respect of the property.

